

图例	1	2	3	4	5	6	7	8	9	10	11	12	13	14	15	16	17	18	19	20	21	22	23	24
接触直径	1.50mm	1.50mm	1.50mm	1.50mm	1.50mm	1.50mm	1.50mm	1.50mm	1.50mm	1.50mm	1.50mm	1.50mm	1.50mm	1.50mm	1.50mm	1.50mm	1.50mm	1.50mm	1.50mm	1.50mm	1.50mm	1.50mm	1.50mm	1.50mm
接触直径	1.00mm	1.00mm	1.00mm	1.00mm	1.00mm	1.00mm	1.00mm	1.00mm	1.00mm	1.00mm	1.00mm	1.00mm	1.00mm	1.00mm	1.00mm	1.00mm	1.00mm	1.00mm	1.00mm	1.00mm	1.00mm	1.00mm	1.00mm	1.00mm

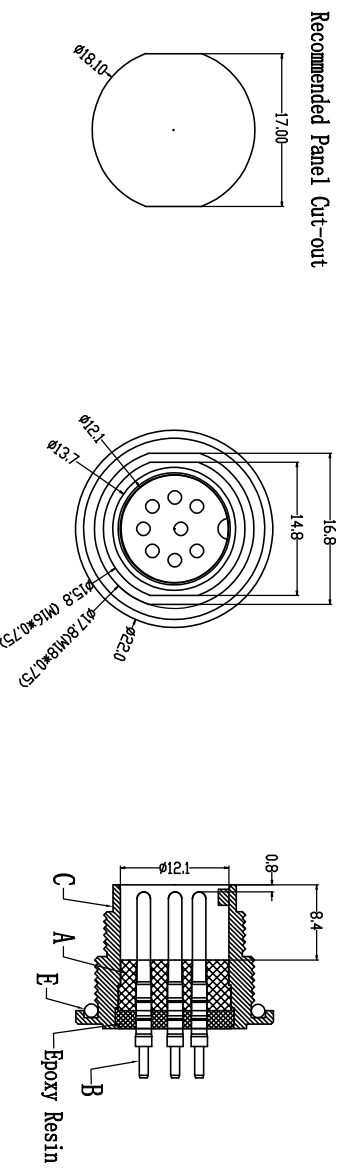

Dongguan Changjun Electronics Co., LTD
东莞市昌骏电子有限公司

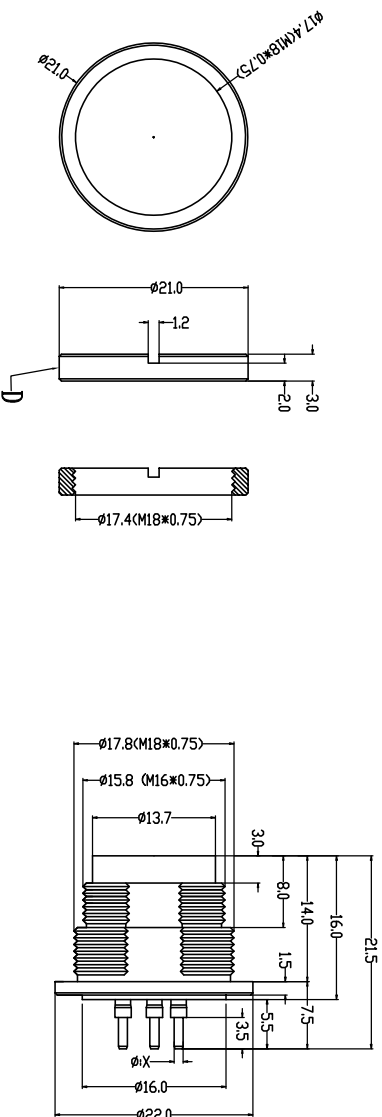
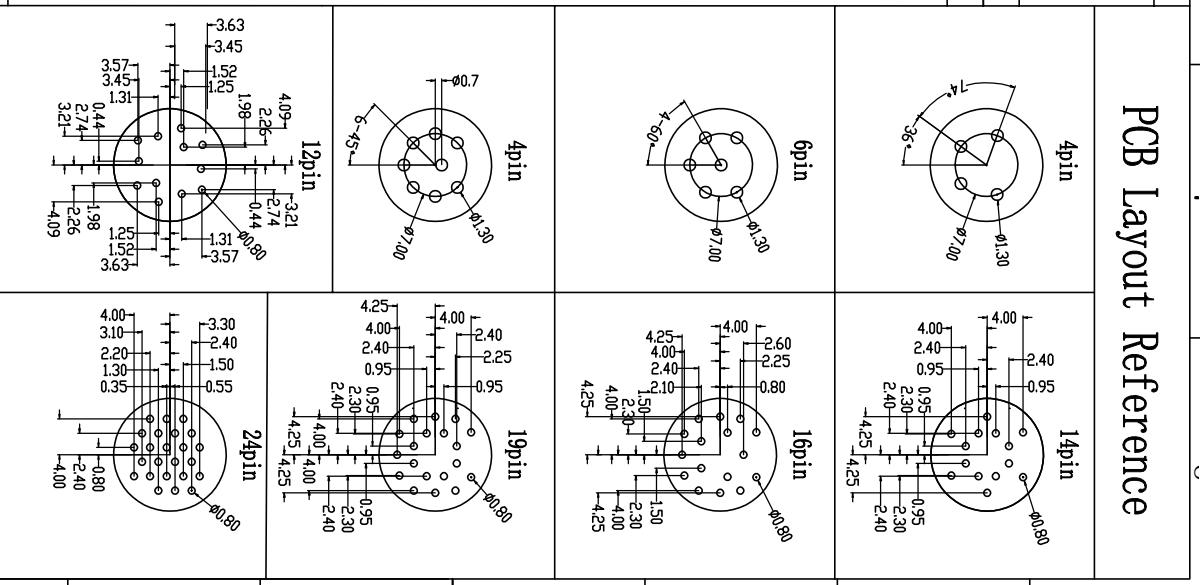

Engagement force	$\leq 60N$	Rated voltage	3.8kV~220V 1.2~19kV~60V 2.0kV~60V
Disengagement force	$\geq 15N$	Rated current	3.8A~1.5A 1.2~19A~3A 2.0A~1A
Mechanical lifespan	≥ 500	Insulation resistance	$\geq 1000M \Omega$
IP rating	IP65/IP67	Contact resistance	$\leq 10m \Omega$
Flammability	UL94 V-0	Operation Temperature	-25° C~105° C

PARTS	MATERIALS	TREATMENT	AMOUNT
A HOUSING	PBT+GF	BLACK	1
B CONTACT	BRASS	GOLD PLATED	3~24
C OUTER CONTACT	BRASS	NICKL. PLATED	1
D NUT	BRASS	NATURAL COLOR	1
E O-RING	EPDM	RED/BLACK	1

TITLE:	M16板3~24pin端子 前后面板式M18 F22T-21.5L
PART NO.:	CP-M16A010
DRWG. NO.:	CP-M16A010
SCALE:	1:1
UNIT:	mm
SIZE:	A4
REV:	A/0
DRAWN:	Xie Wenjun
CHECK:	Long Jichang
DATE:	2023-08-01