

PIN数	3pin	4pin	5pin	6pin	7pin	8pin	12pin	14pin	16pin	19pin	24pin
图纸											
接触直径	1.50mm	1.50mm	1.50mm	1.50mm	1.50mm	1.50mm	1.00mm	1.00mm	1.00mm	1.00mm	0.50mm

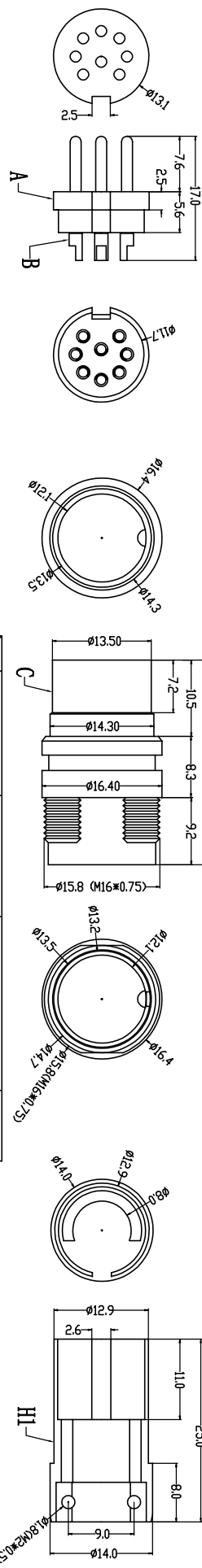
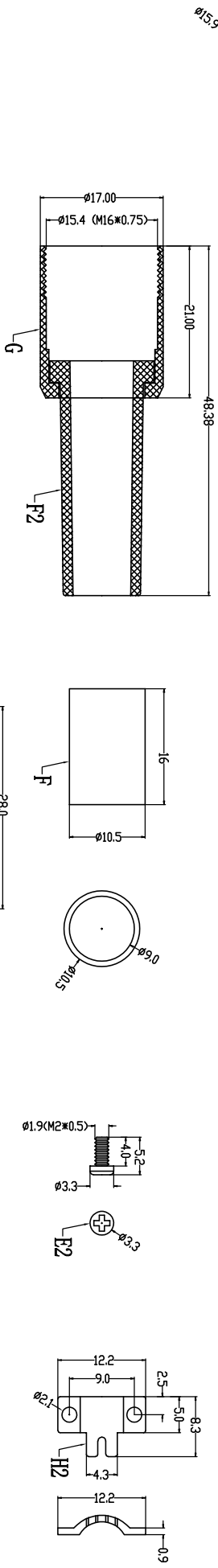
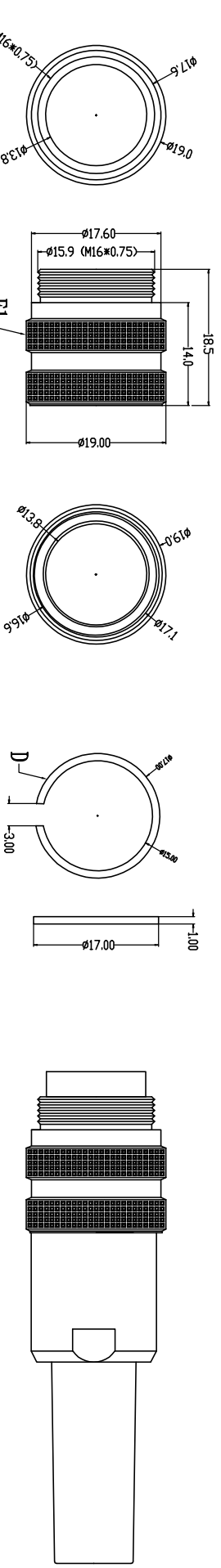

PARTS	MATERIALS	TREATMENT	AMOUNT
A HOUSING	PBT+GF	BLACK	1
B CONTACT	BRASS	GOLD PLATED	3~24
C OUTER CONTACT	ALALLOY	NICKL PLATED	1
D SNAP RING	SS	NATURAL COLOR	1
E NUT	BRASS/SPE-SD	NICKL PLATED	1+2
F PROTECTIVE SHEATH	PVC	NATURAL COLOR	1+1
G NUT	PA66+GF	BLACK	1
H HOUSING	ALALLOY/SPE-SD	NICKL PLATED	1+1

Engagement force	≤60N	Rated voltage	3.8kV~220V 1.2~1.9kV~60V 2.0kV~60V
Disengagement force	≥15N	Rated current	3.8pin:5A 1.2~1.9pin:3A 2.0pin:1A
Mechanical lifespan	≥500	Insulation resistance	≥1000M Ω
IP rating	IP65/IP67	Contact resistance	≤10m Ω
Flammability	UL94 V-0	Operation Temperature	-25° C~105° C

TITLE: M16*0.75 24P线端公头 (塑胶组装式)
 DONGGUAN CHANGJUN ELECTRONICS CO., LTD
 东莞市昌骏电子有限公司

TOLERANCE	±0.05 ±0.10 ±0.30 ±0.50	PART NO:	CJ-M16AXB-M03	DRAWING NO.:	CP-M16A003
ANGLE	±1°	SHEET:	1 / 1	SCALE:	1 : 1
DRAWN:	Xie Wenjun	UNIT:	mm	SIZE:	A4
CHECK:	Long Jichang	REV:	A/0	DATE:	2023-05-05