

A	pin位	1	2	3	4	6	8
	X 值	1.50	1.00	1.00	1.00	1.00	1.00
B	图形						

Recommended Panel Cut-out

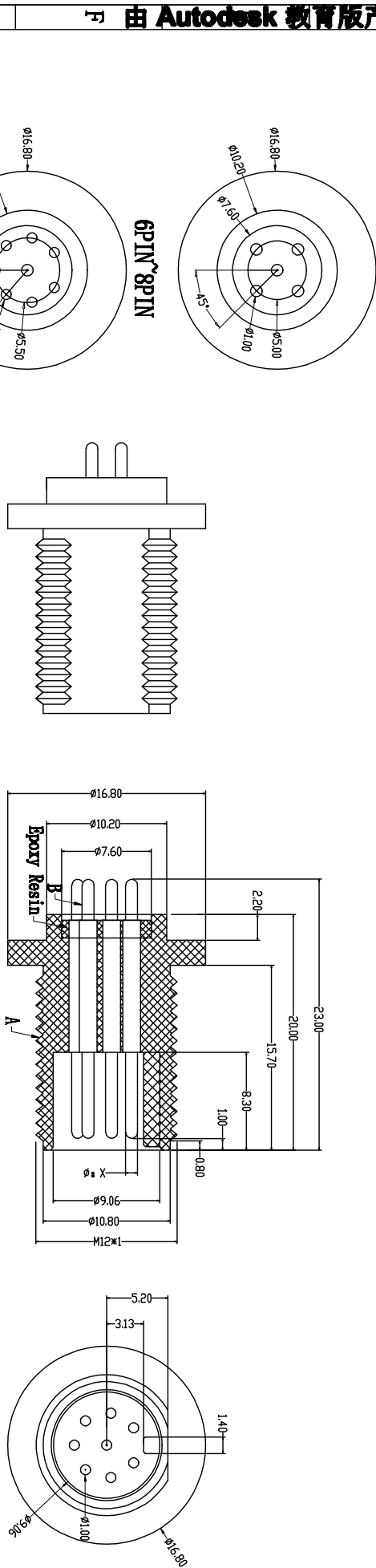
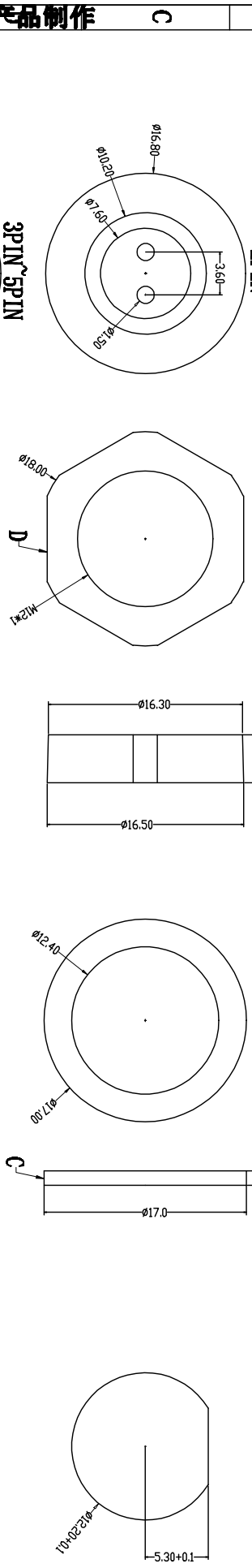

G	Engagement force	≤50N	Rated voltage	5-10VDC
	Disengagement force	≥5N	Rated current	2pin: 1A 3pin: 1A
F	Mechanical lifespan	≥500	Insulation resistance	≥1000MΩ
	IP rating	IP67/IP68	Contact resistance	≤10mΩ
E	Flammability	UL94 V-0	Operation Temperature	-40° C~105° C

PARTS	MATERIALS	TREATMENT	AMOUNT
A	HOUSING PA66+GF	BLACK	1
B	CONTACT BRASS	GOLD PLATED	2*8
C	SHIM SILICA GEL	BLACK	1
D	NUT PA66+GF	BLACK	1

Dongguan Changjun Electronics Co., LTD
东莞市昌骏电子有限公司

H	TOLERANCE	.xxx ±0.05 ±0.10 ±0.20 ±0.50	TITLE:	M12防水型板端公头 背面面板式-CJK
	ANGLE	± 1°	PART NO.:	GF-M12A16(3)-M10-CJ
I	DRAWN:	Xie Wenjun	CHECKS:	Long Jibang
	DATE:	2022-01-05	DRAWING NO.:	GF-M120114
J	SHEET:	1 / 1	SCALE:	1 : 1
	UNIT:	mm	SIZE:	REV A/0