

A	1	2	3	4	5	6	7	8				
B	2pin	3pin	4pin 正方形	5pin 正方形	5pin 正方形 (2+3)	5pin 360°	6pin 360°	6pin 258°	6pin (8x6)	7pin	8pin	

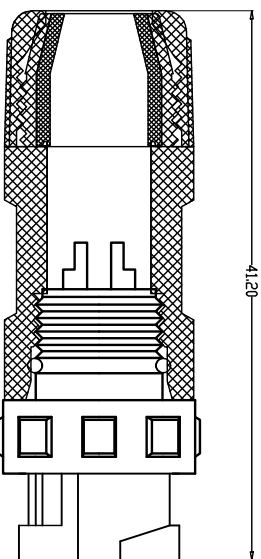
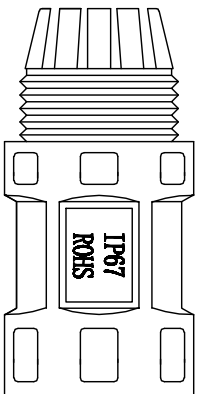
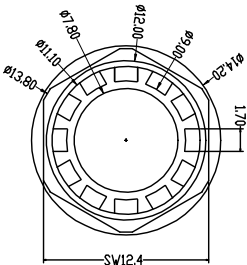
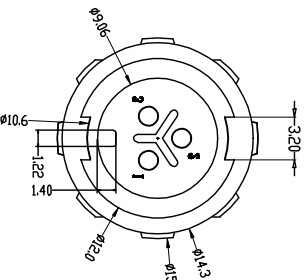
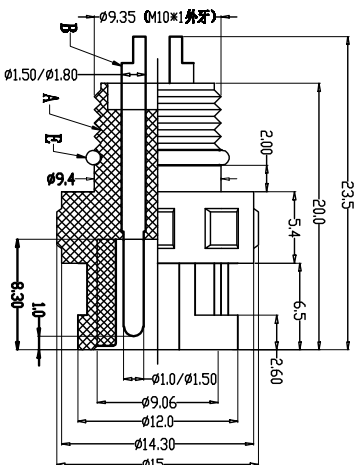
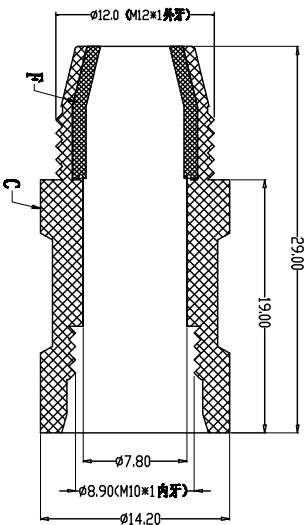
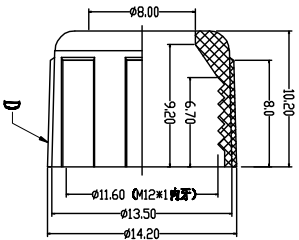

由 Autodesk 教育版产品制作

由 Autodesk 教育版产品制作

PARTS	MATERIALS	TREATMENT	AMOUNT
A HOUSING	PA66+GF	BLACK	1
B CONTACT	BRASS	GOLD PLATED	2*8
C SHELL	PA66+GF	BLACK	1
D NUT	PA66+GF	BLACK	1
E O-RING	SILICA GEL	RED	1
F O-RING	SILICA GEL	BLACK	1

Engagement force	≤50N	Rated voltage	50VAC/110VAC
Disengagement force	≥5N	Rated current	2-3pin: 1.0A 4-6pin: 0.5A
Mechanical lifespan	≥500	Insulation resistance	≥1000MΩ
IP rating	IP67/IP68	Contact resistance	≤10mΩ
Flammability	UL94 V-0	Operation Temperature	-40° C~105° C

Dongguan Changjun Electronics Co., LTD	
东莞市昌骏电子有限公司	
TITLE:	12型快插式防水28芯接插件 插配式
PART NO.:	DR-1120208
SCALE:	1:1
UNIT:	mm
SIZE:	REV A/0
DRAWN:	Xie Wenjun
CHECK:	Long Jichang
DATE:	2022-01-05